

instructions

Network – Set up manual

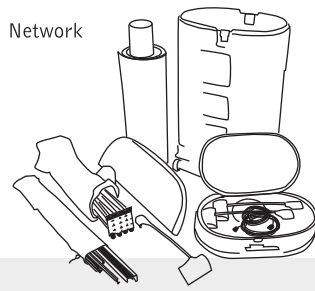

Network

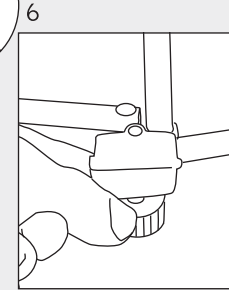
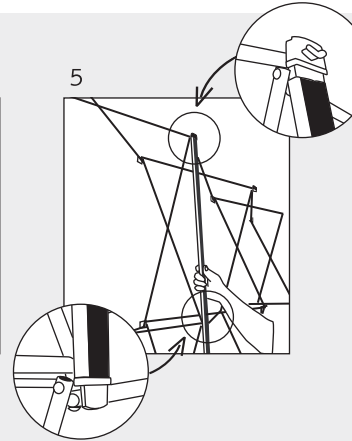
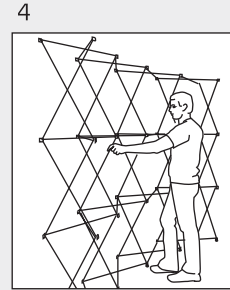
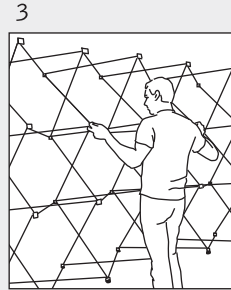
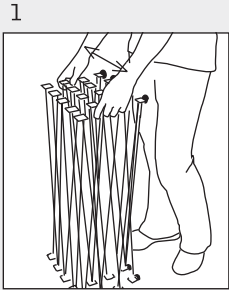

Bitte beachten:

Pos 3: Stellen Sie beim Aufbau sicher, dass die FüÙe nach unten zeigen! Diese können Sie verdrehen, um Unebenheiten des Bodens auszugleichen (Pos 6).

Pos 7: IMMER die Motivfläche nach AUSSEN rollen!! Sonst entstehen Knicke und Falten in der Oberfläche des Panels!

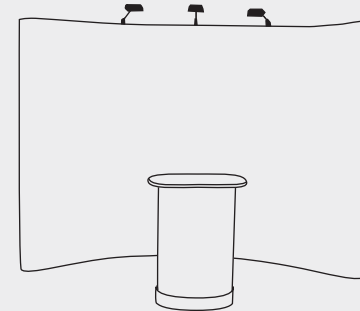
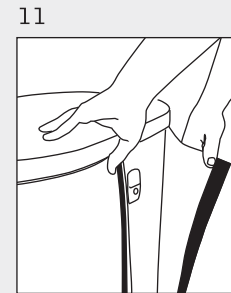
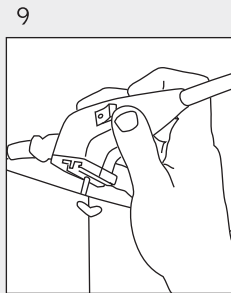
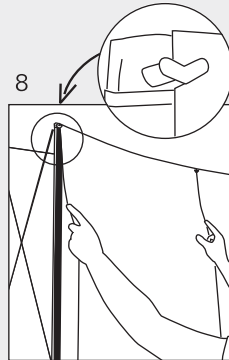
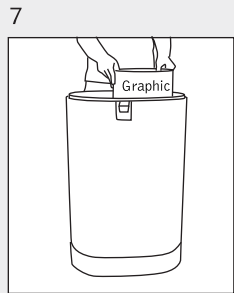

Network frost

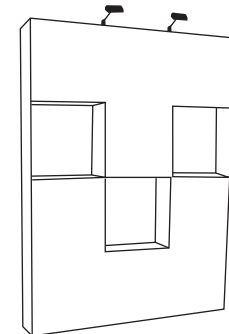
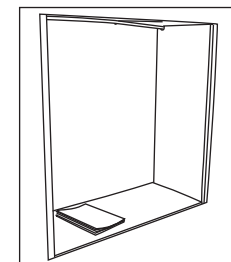
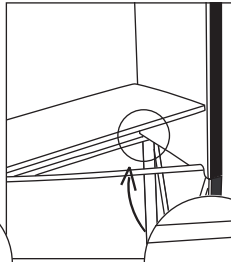
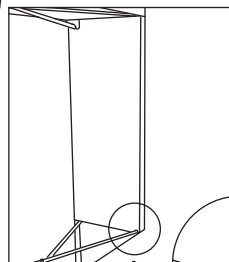
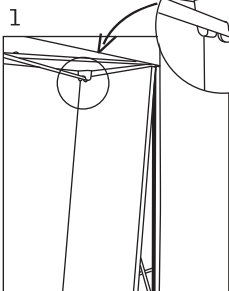

Network Frost:

Network Display mit speziellen Vitrineneinsätzen aus gefrorenem Glas